

DETALJ 1
Håltagning lucköppning

Skala 4:1

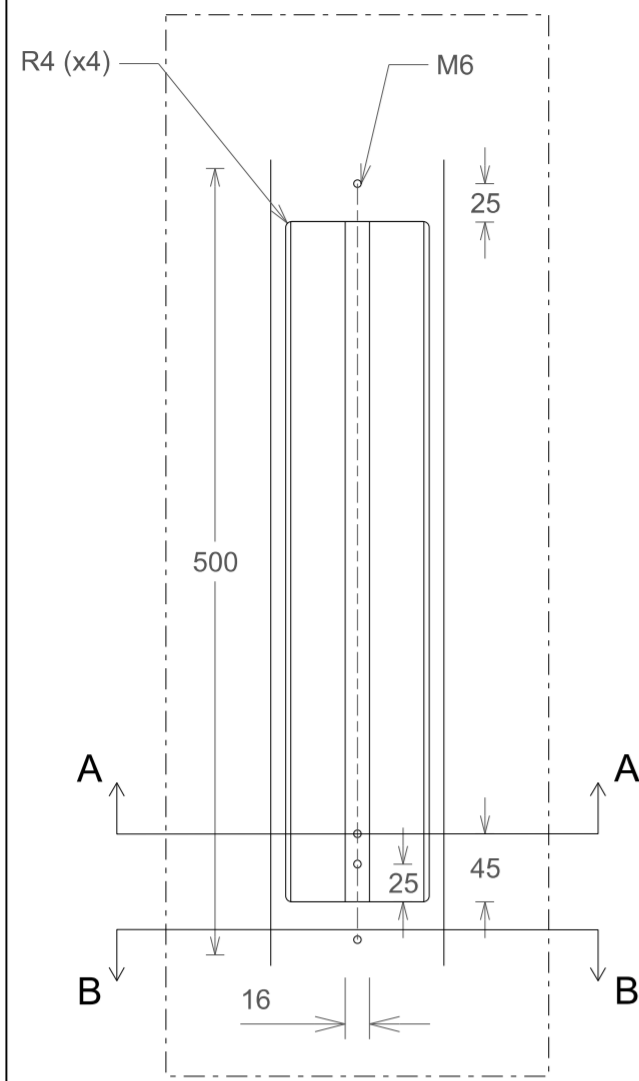

SNITT A - A
Stolpe vid lucköppning

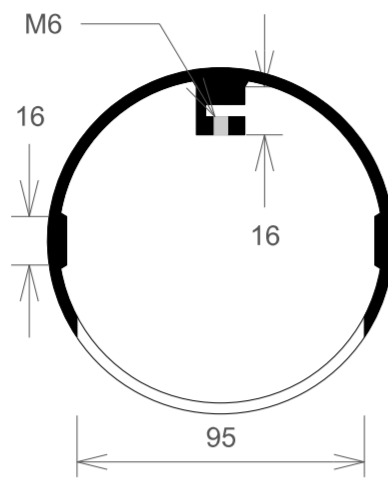

SNITT B - B
Stolpe

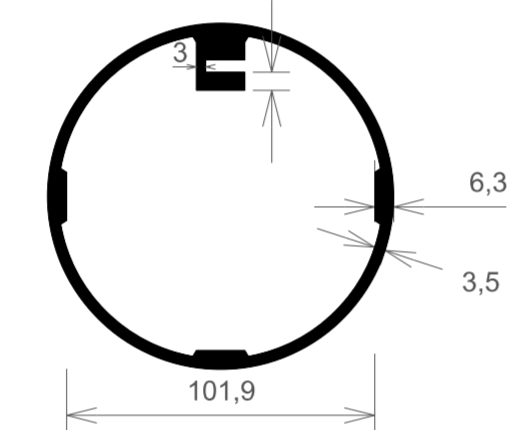

STOLPE
Framsida

Skala 3:1

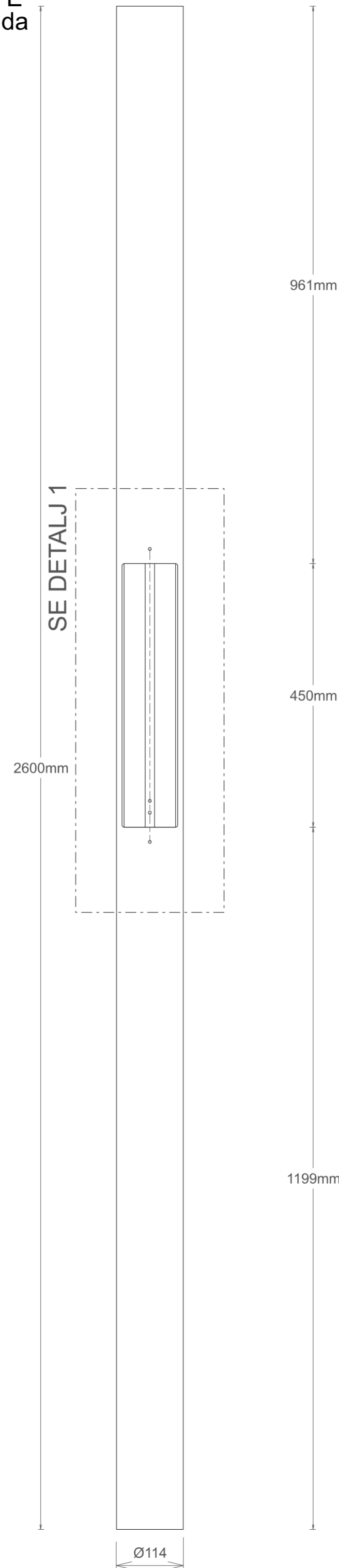

STOLPLUCKA
Typ 1

Skala 4:1

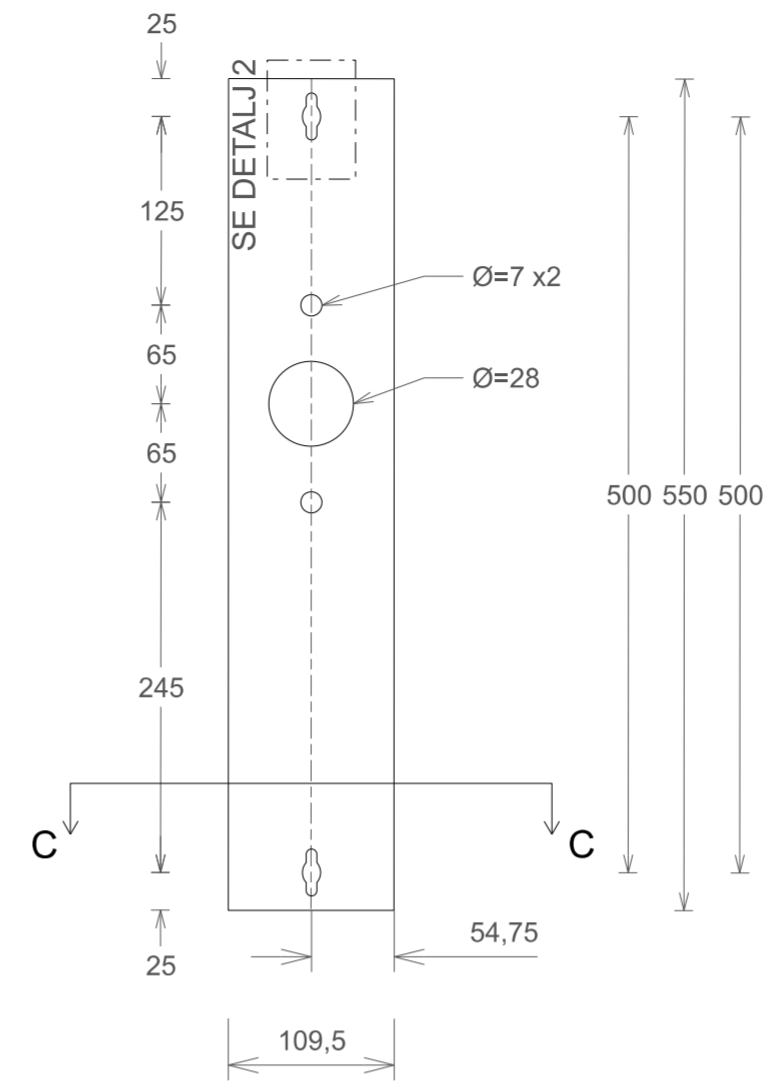

SNITT C - C
Stolplucka

Skala 4:1

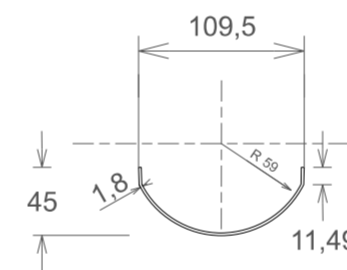

STOLPLUCKA
Typ 2

Skala 4:1

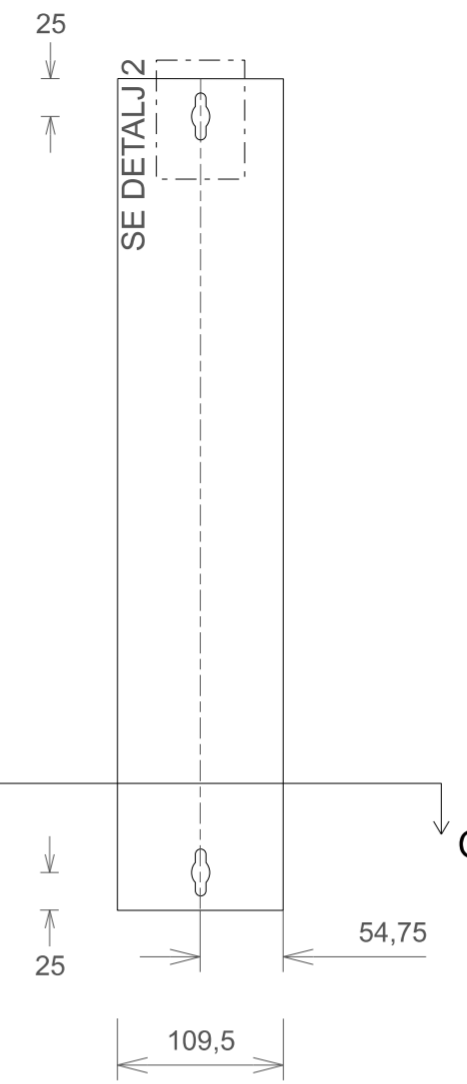

DETALJ 2
Hålbild

Skala 16:1

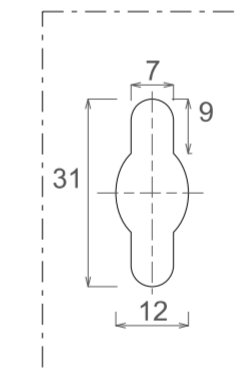

TECKENFÖRKLARING

ANGIVNA MÅTT ÄR I mm.

ALUMINIUMSTOLPE Ts6139

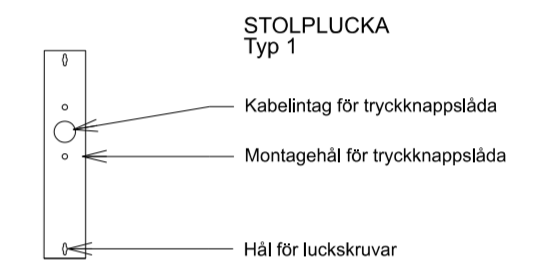
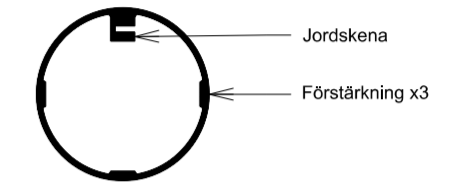
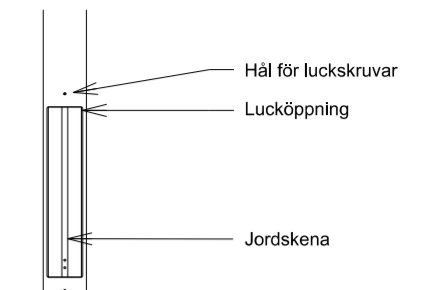

FÖRESKRIFTER

ALUMINIUMSTOLPE:

MATERIAL: EN AW-6060 T6
SKRUV: FÖR M6 GÅNGA SKA VARA MED 5mm INSEX SKALLE
MÅLNING: STOCKHOLMSGRÖN, RAL6009

HÄNVISNING

REFLEXTEJ.P SE Ts5588

Status
TH-TYPRITNING

Datum: 2024-03-04
Godkänd av: Amanuel Aydin
Ritad av: Linda Benderius



Trafikkontoret

TRAFIKSIGNALER
Aluminiumstolpe 2600 mm

Produktionsritning

Ritningsnr
Ts6139

Rev.
-